

YOUTH BUILDING PROPOSAL

1. The Vision

Several years ago our Long Range Planning Committee proposed several goals for our church, one of which was that we would provide the necessary educational space to accommodate 750 people in Sunday School. Our new Preschool/Children's building and the Senior Adult remodeling project were our first efforts to make this vision a reality. It is now time to address the needs of our Youth.

2. The Need

Presently our Youth are meeting in various places scattered throughout our facilities. Sunday morning they meet in the Awana room in the Preschool/Children's building for large group activities and then move to classrooms upstairs in the FLC for smaller groups. Sunday and Wednesday night the Youth meet in the chapel in the Senior Adult area. In the last six months we have experienced sustained growth in our Youth but present available space will not allow us to continue to grow.

3. The Plan

The Youth Building Committee is proposing that we construct a 90 x 84 steel metal building south of our FLC in the space now occupied by the portable buildings. This building would be the same height as our FLC and would be connected by an enclosed walkway to the FLC similar to the corridor connecting the Preschool/Children's Building to the FLC. It would be constructed in such a manner that a second story could be added later. This 7,580 square foot building would accommodate 150 youth which would allow our youth group to double in size. The estimated cost for this building is \$500,000.

YOUTH BUILDING PROPOSAL

1. The Vision

Several years ago our Long Range Planning Committee proposed several goals for our church, one of which was that we would provide the necessary educational space to accommodate 750 people in Sunday School. Our new Preschool/Children's building and the Senior Adult remodeling project were our first efforts to make this vision a reality. It is now time to address the needs of our Youth.

2. The Need

Presently our Youth are meeting in various places scattered throughout our facilities. Sunday morning they meet in the Awana room in the Preschool/Children's building for large group activities and then move to classrooms upstairs in the FLC for smaller groups. Sunday and Wednesday night the Youth meet in the chapel in the Senior Adult area. In the last six months we have experienced sustained growth in our Youth but present available space will not allow us to continue to grow.

3. The Plan

The Youth Building Committee is proposing that we construct a 90 x 84 steel metal building south of our FLC in the space now occupied by the portable buildings. This building would be the same height as our FLC and would be connected by an enclosed walkway to the FLC similar to the corridor connecting the Preschool/Children's Building to the FLC. It would be constructed in such a manner that a second story could be added later. This 7,580 square foot building would accommodate 150 youth which would allow our youth group to double in size. The estimated cost for this building is \$500,000.

4. The Process

We would like to complete the project and have the building ready by September 1, 2008.

This will require us to obtain a construction loan for up to \$500,000. Resources available to help pay for the project include sale of the portable buildings-\$50,000 and the Mission House-\$125,000. A capital fund raising project (conducted by our church without a consultant) would need to raise only \$325,000 in one year to completely pay for the building. Based upon the loan balance and pledges yet to be received for our Preschool/Children's building, our current loan should be paid off this year. By December 31, 2009 our church would have no long term building debt, and our vision for having educational space to accommodate 750 in Sunday School would be complete.

Current Proposed Building Layout Includes:

- Restrooms with showers
- Snack Area
- Worship Area
- Game Areas
- Computer / Conference Rm
- Couch Area

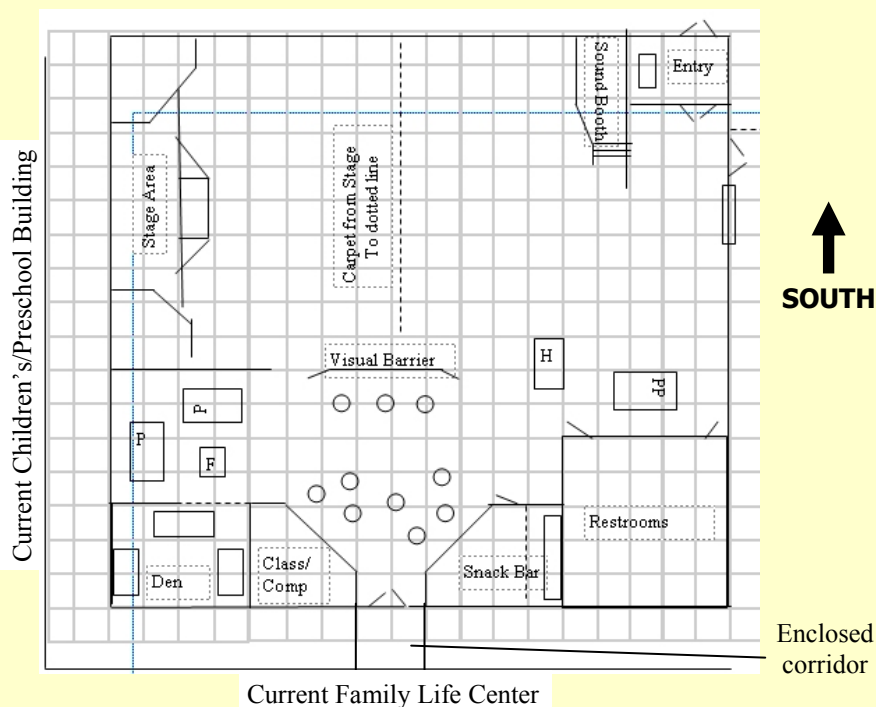

4. The Process

We would like to complete the project and have the building ready by September 1, 2008.

This will require us to obtain a construction loan for up to \$500,000. Resources available to help pay for the project include sale of the portable buildings-\$50,000 and the Mission House-\$125,000. A capital fund raising project (conducted by our church without a consultant) would need to raise only \$325,000 in one year to completely pay for the building. Based upon the loan balance and pledges yet to be received for our Preschool/Children's building, our current loan should be paid off this year. By December 31, 2009 our church would have no long term building debt, and our vision for having educational space to accommodate 750 in Sunday School would be complete.

Current Proposed Building Layout Includes:

- Restrooms with showers
- Snack Area
- Worship Area
- Game Areas
- Computer / Conference Rm
- Couch Area

